



EADIPS®
FGR®

**European Association for
Ductile Iron Pipe Systems**

Fachgemeinschaft Guss-Rohrsysteme

EADIPS®/FGR® STANDARD

2013-06

Ductile iron fittings
End caps for sockets
Dimensions

EADIPS®/FGR® 59

Formstücke aus duktilem Gusseisen

P-Stücke

Maße

Replaces 2012-02 edition

Amendments

To Normative references

To dimensions

Contents

Page

1. Scope	2
2. Normative references	2
3. End caps for sockets - dimensions	3
4. Material, coatings	4
5. Marking	4

Except where consented to by the European Association for Ductile Iron Pipe Systems · EADIPS® / Fachgemeinschaft Guss-Rohrsysteme (FGR®) e. V., EADIPS®/FGR® standards may only be published or reproduced with their form and content unamended. The consent of the EADIPS®/FGR® is required for the reproduction of an EADIPS®/FGR® standard in any shortened form.

European Association for Ductile Iron Pipe Systems · EADIPS® / Fachgemeinschaft Guss-Rohrsysteme (FGR®) e. V.
Im Leuschnerpark 4 · 64347 Griesheim/Germany · E-Mail: info@eadips.org · www.eadips.org

1. Scope

Because ductile iron end caps for sockets for water pipelines and sewer pipelines are not covered in EN 545 or EN 598, this standard specifies their dimensions.

2. Normative references

EN 545

Ductile iron pipes, fittings, accessories and their joints for water pipelines –
Requirements and test methods
2010

EN 598

Ductile iron pipes, fittings, accessories and their joints for sewerage applications –
Requirements and test methods
2007+A1:2009

DIN 28601

Ductile iron pipes and fittings - Screwed socket joints -
Assembly, sockets, screw rings, sealing rings and slip rings
2000-06

DIN 28603

Ductile iron pipes and fittings - Push-in joints –
Survey, sockets and gaskets
2002-05

EADIPS®/FGR® 33

Ductile iron pipes and fittings -
Marking of ductile iron pipes and fittings
2013-06

3. End caps for sockets - dimensions

Symbol

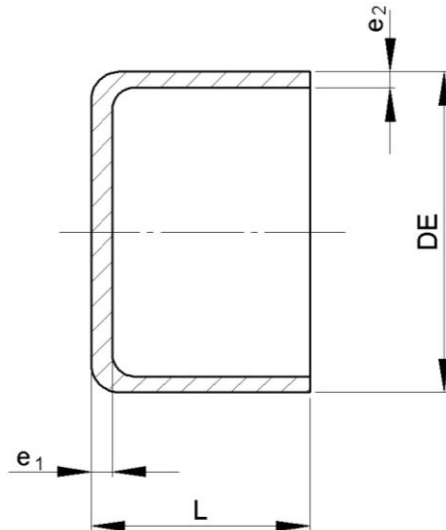

DE must be within the limit deviation G when measured at L/2 from the spigot end

Dimensions in mm

DN	Outside diameter DE				
	Nominal value	Limit deviation G	L (min.)	e ₁ (min.)	e ₂ (min.)
80	98	+1 -2,7	90	9,0	7,0
100	118	+1 -2,8	98	9,5	7,2
125	144	+1 -2,8	99	12,0	7,5
150	170	+1 -2,9	103	12,0	7,8
200	222	+1 -3,0	108	14,0	8,4
250	274	+1 -3,1	120	16,0	9,0
300	326	+1 -3,3	125	18,0	9,6
350	378	+1 -3,4		22,0	10,2
400	429	+1 -3,5		24,0	10,8
500	532	+1 -3,8	173	25,0	12,0

End caps for sockets may also be supplied in a positive locking form or with threaded bores (see manufacturer's catalogues).

4. Material, coatings

Material and coatings are to be in accordance with EN 545 for water pipelines and in accordance with EN 598 for sewer pipelines.

5. Marking

Marking of fittings is to be in accordance with EN 545, EN 598 and EADIPS®/FGR® 33.